

ET157-12060

Installation guide

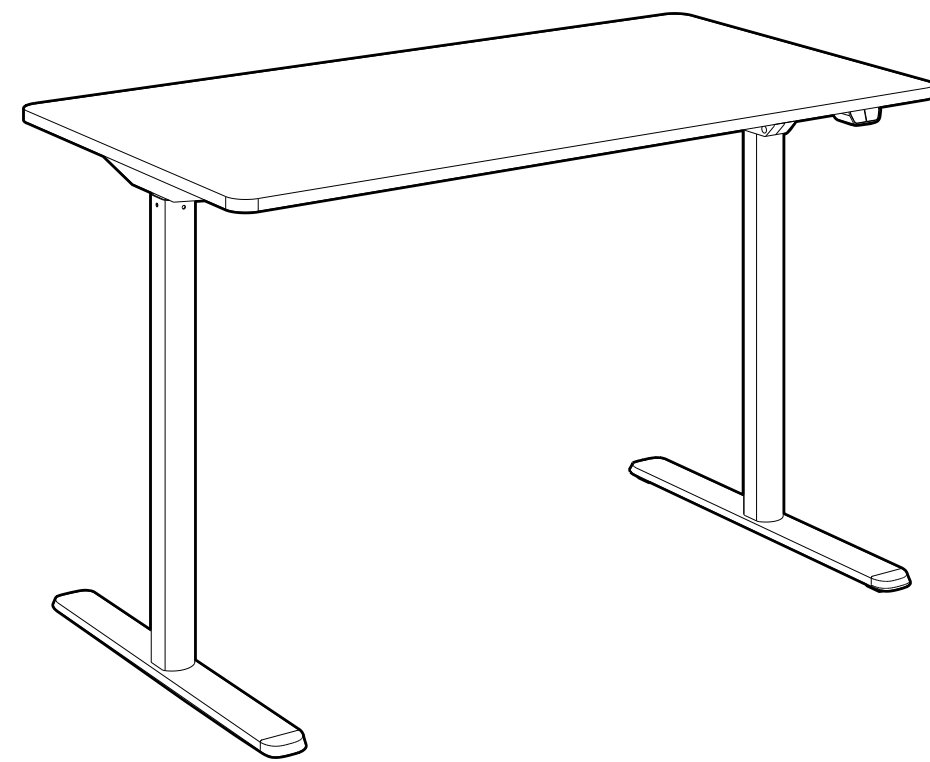

< The pictures below are for reference only, please refer to the actual product. >
Please read this product manual carefully before use, and keep it properly.

Technical Data

Column Stage	2
Max. Load Capacity	50KG
Max. Speed	15mm/s
Lowest Height	725mm
Highest Height	1175mm
Tabletop Size	1200mmx600mm
Usage frequency	10% (Work continuously for 2 minutes, then pause for 18 minutes.)

Product List

Accessory List

Note: The line drawings below are for reference only and may differ slightly from the physical product in some cases. Please refer to the actual product for accuracy. If any tools are missing or there are problems with installation, please contact customer service.

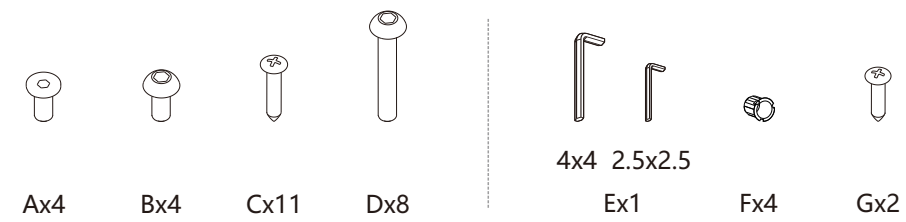

Preparation before installation

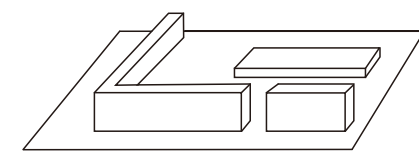

Install on carpet to prevent scratches.

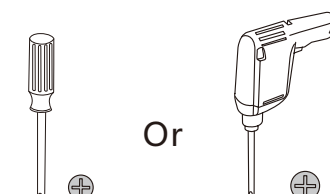

Or
Bring your own pistol drill.

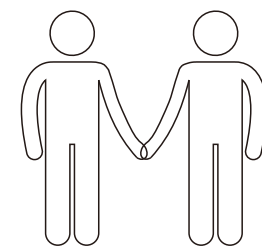

Need two or more people to cooperate together.

Part List

No.	Part
①	Tabletop x1
②	Bracket x2
③	Left Lifting Column x1
④	Right Lifting Column x1
⑤	Supporting Beam x1
⑥	Transmission Rod x1

No.	Part
⑦	Pedestal x2
⑧	Handset x1
⑨	Baffle x1
⑩	Power Plug x1
⑪	Cable Clip x4
⑫	Damping Pad x9

Installation Instruction

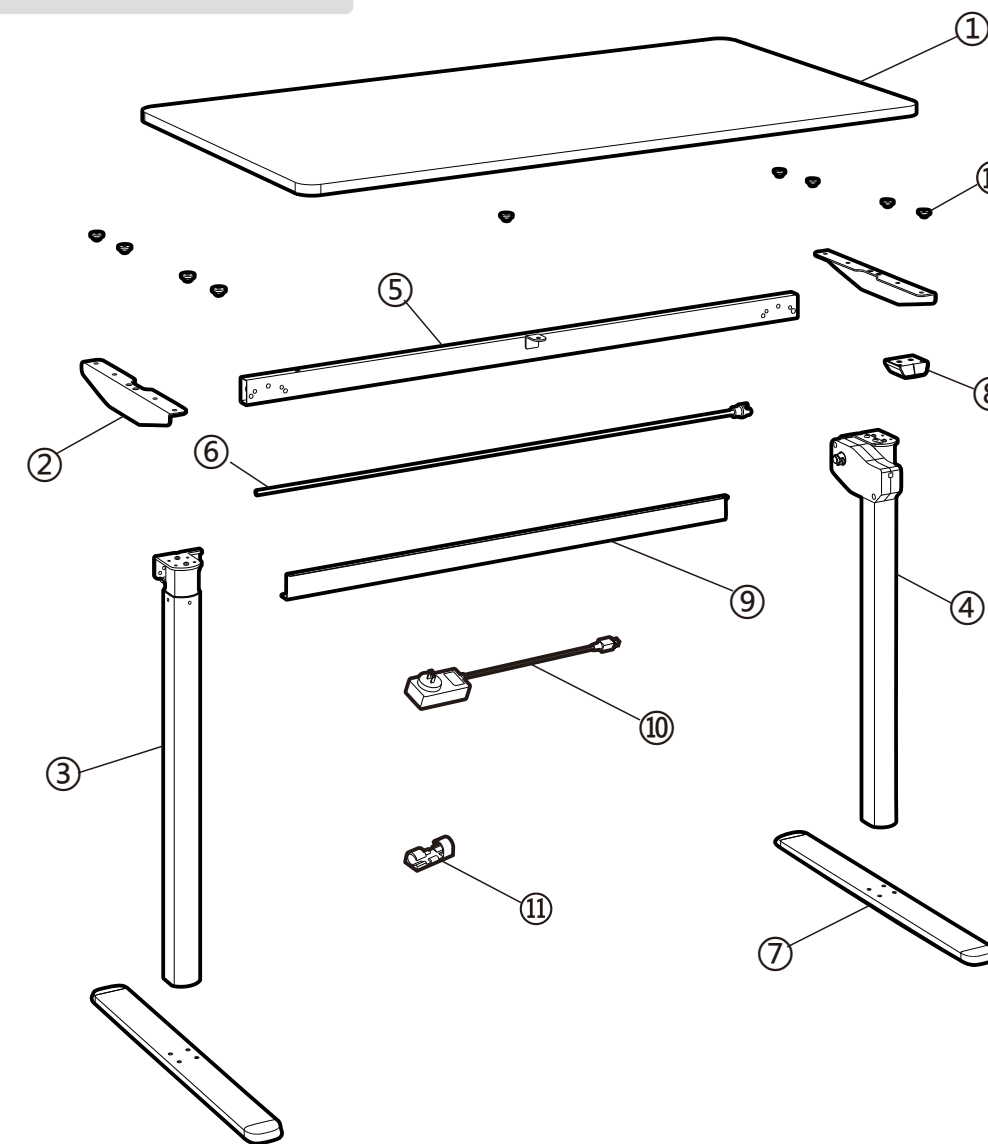

Installation Steps

STEP1 Install the Pedestals

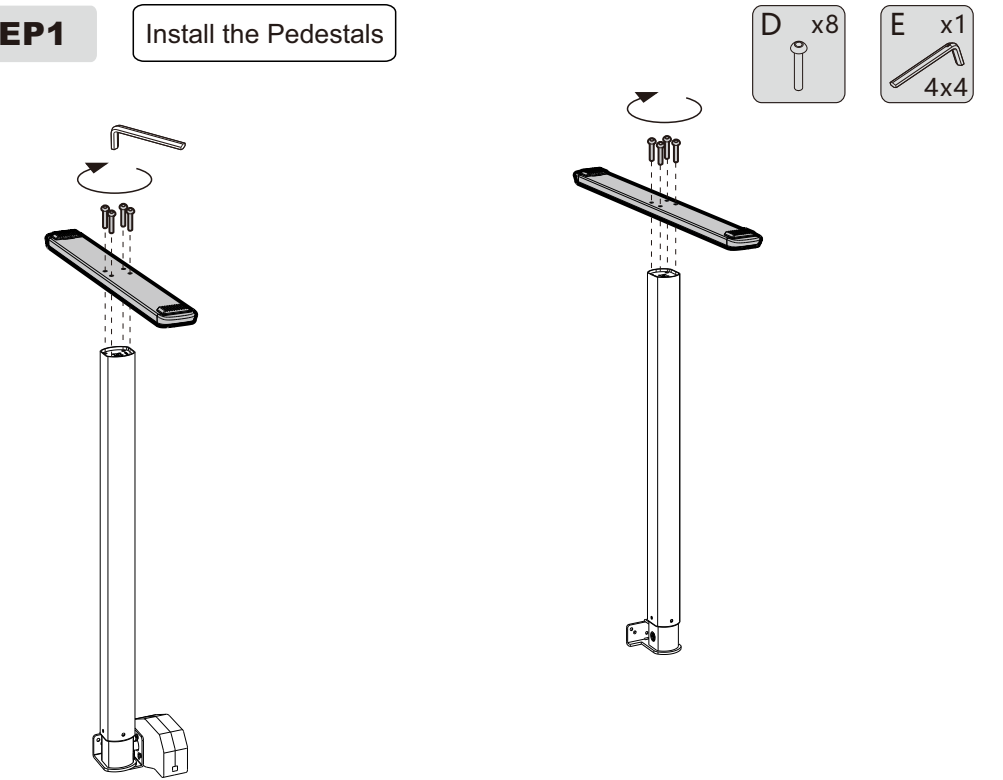

STEP2 Connect the Left Lifting Column to the Beam

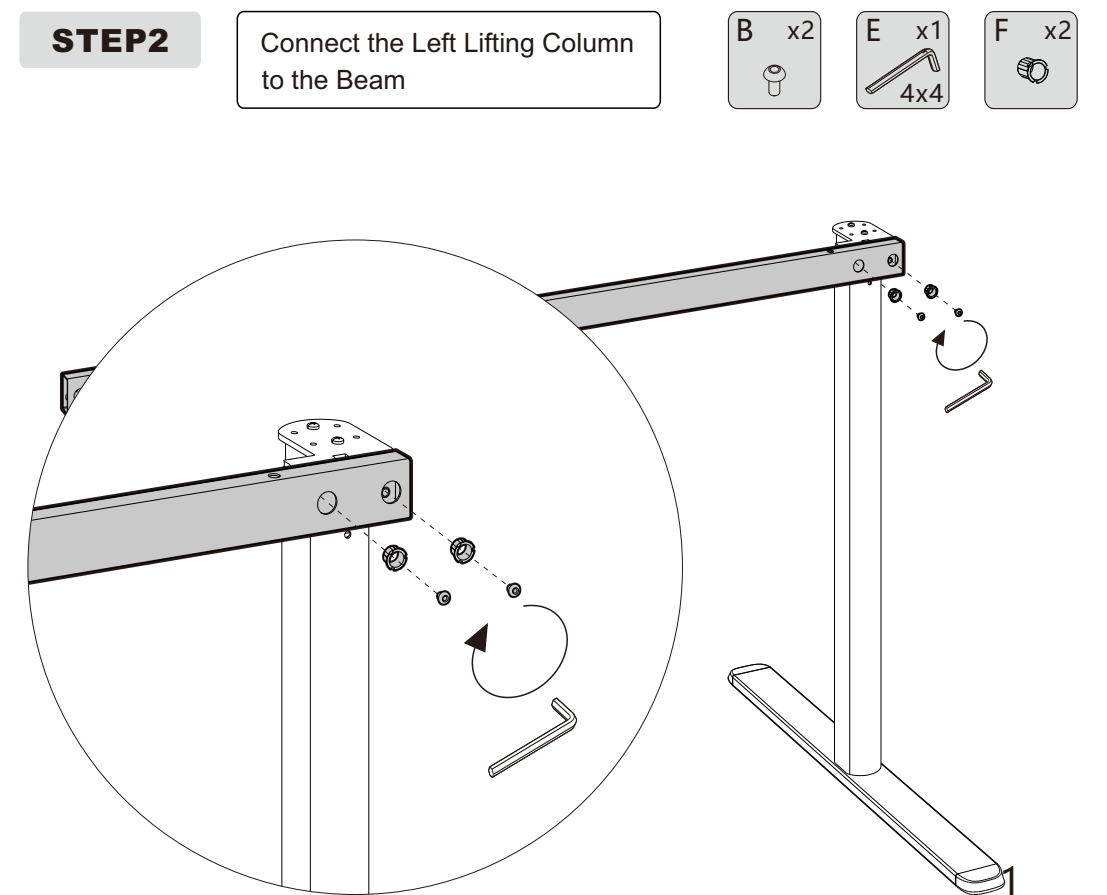

STEP3 Install the Transmission Rod

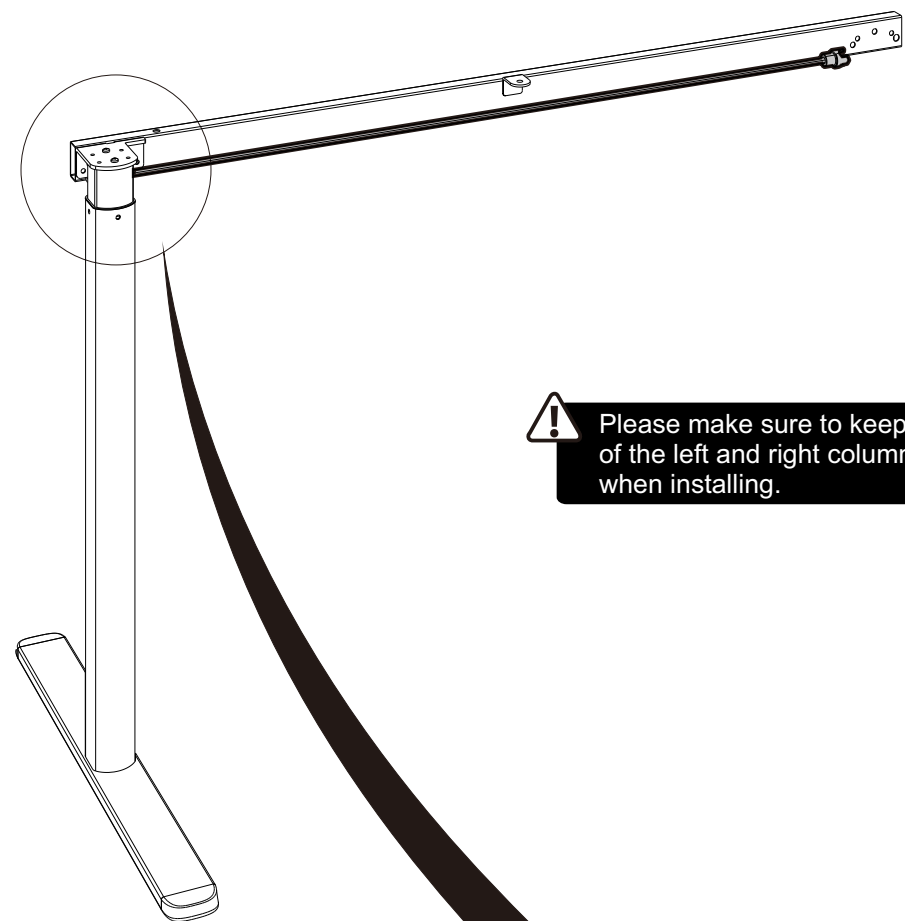

⚠ Please make sure to keep the height of the left and right columns consistent when installing.

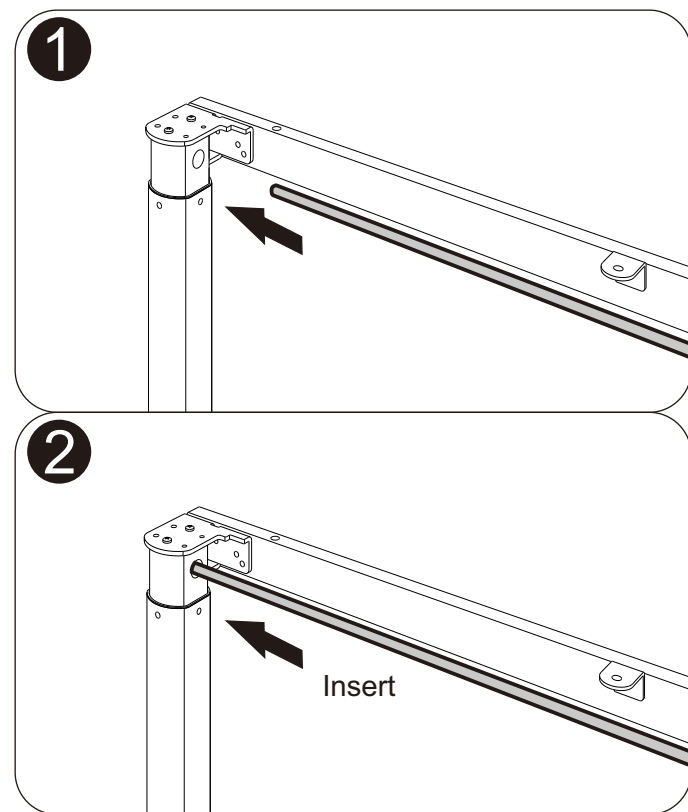

STEP4 Insert the Transmission Rod into the Right Lifting Column

E x1
2.5x2.5

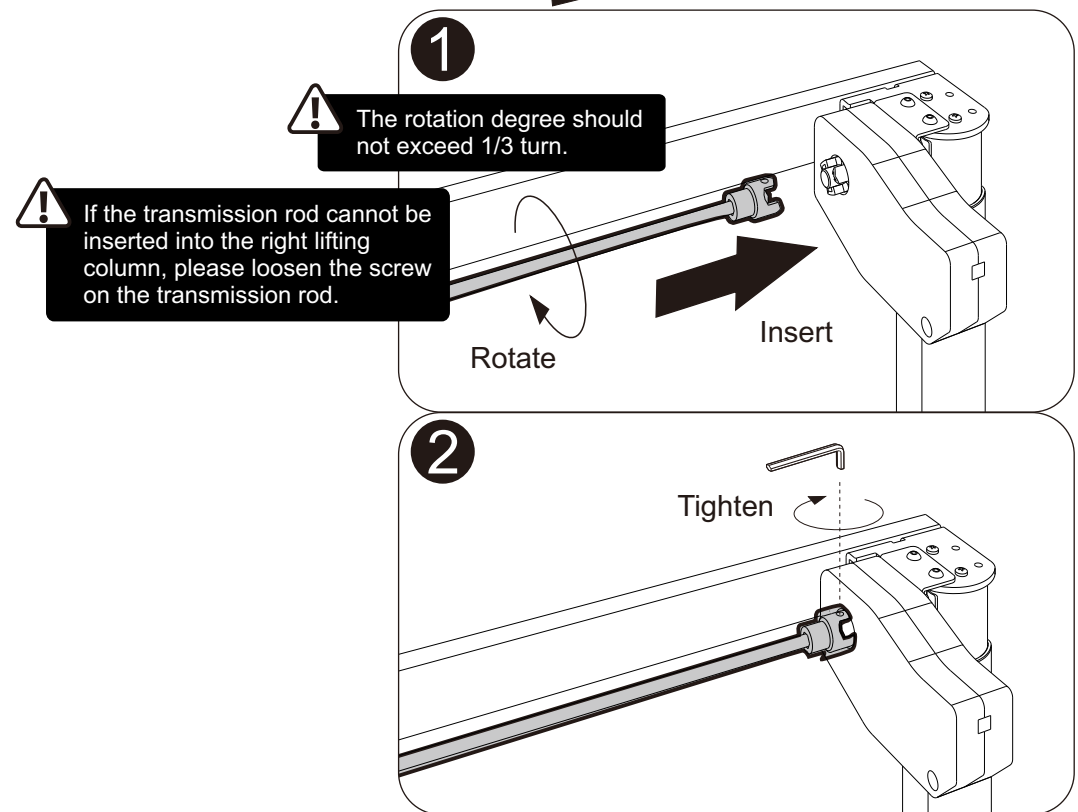
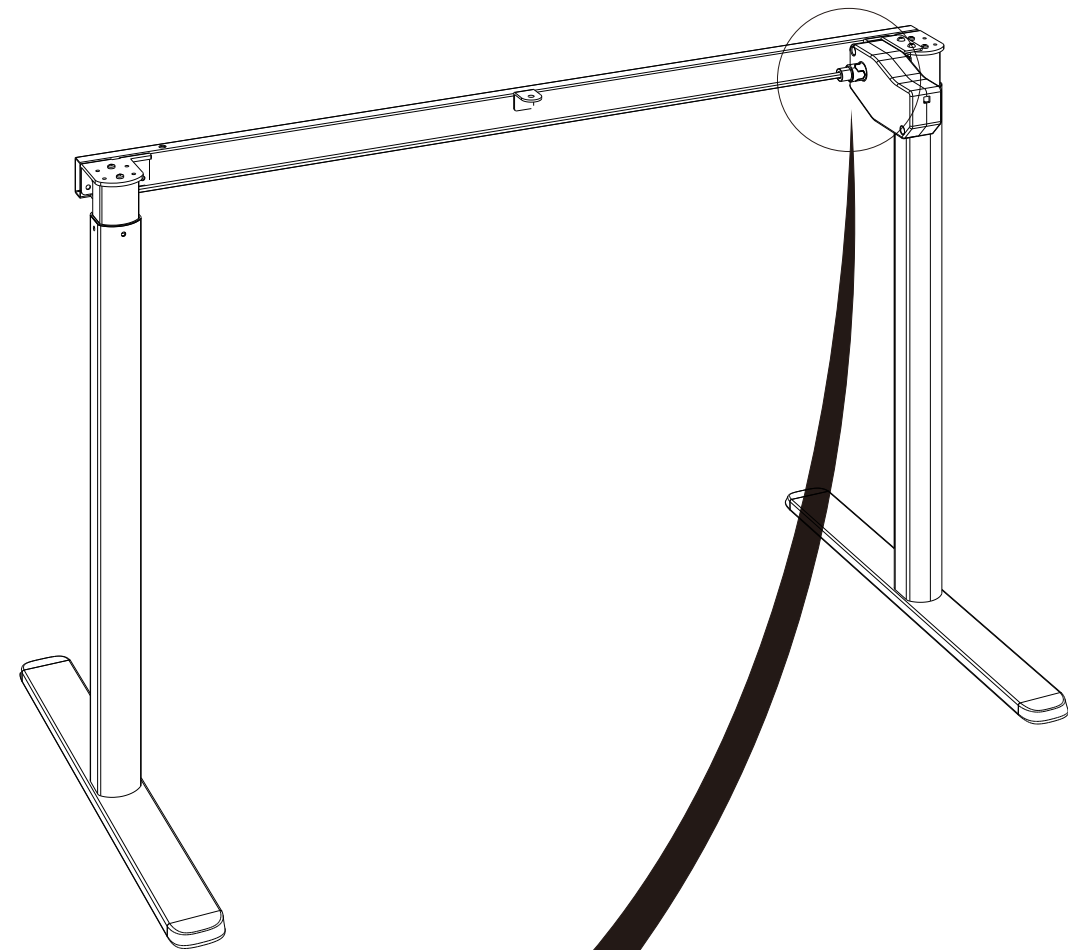

STEP5 Connect the Right Lifting Column to the Beam

B x2
E x1
4x4
F x2

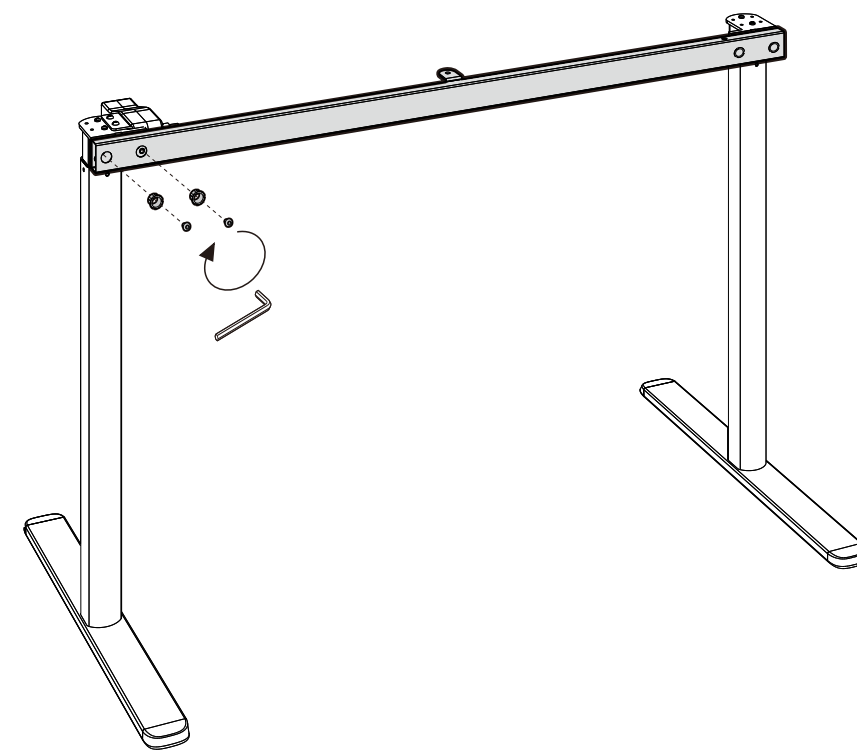

STEP6 Install Brackets

A x4
E x1
4x4

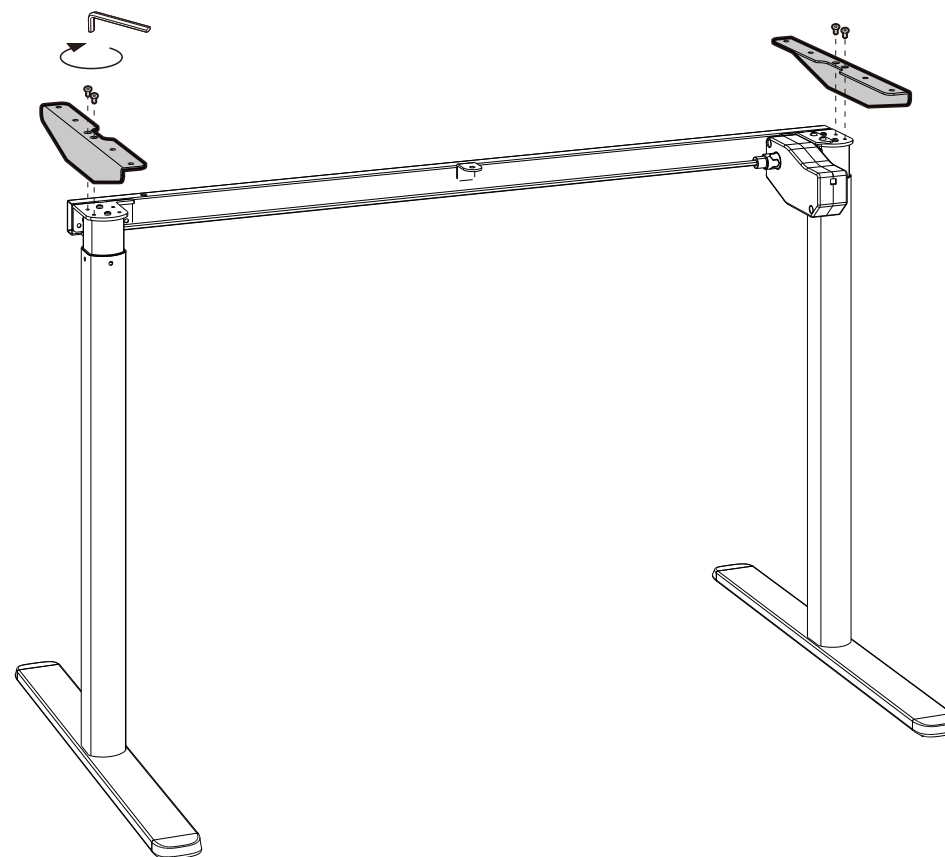

STEP7 Install Damping Pads

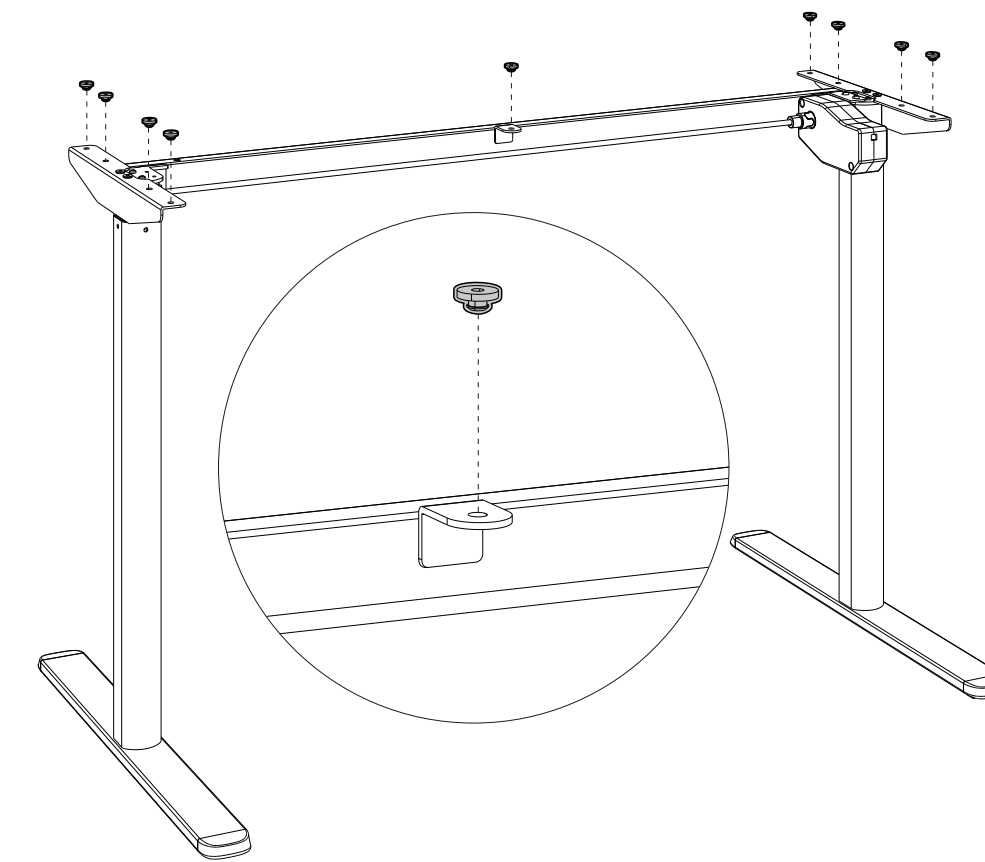

STEP8 Install the Tabletop

C x9
Self-prepared

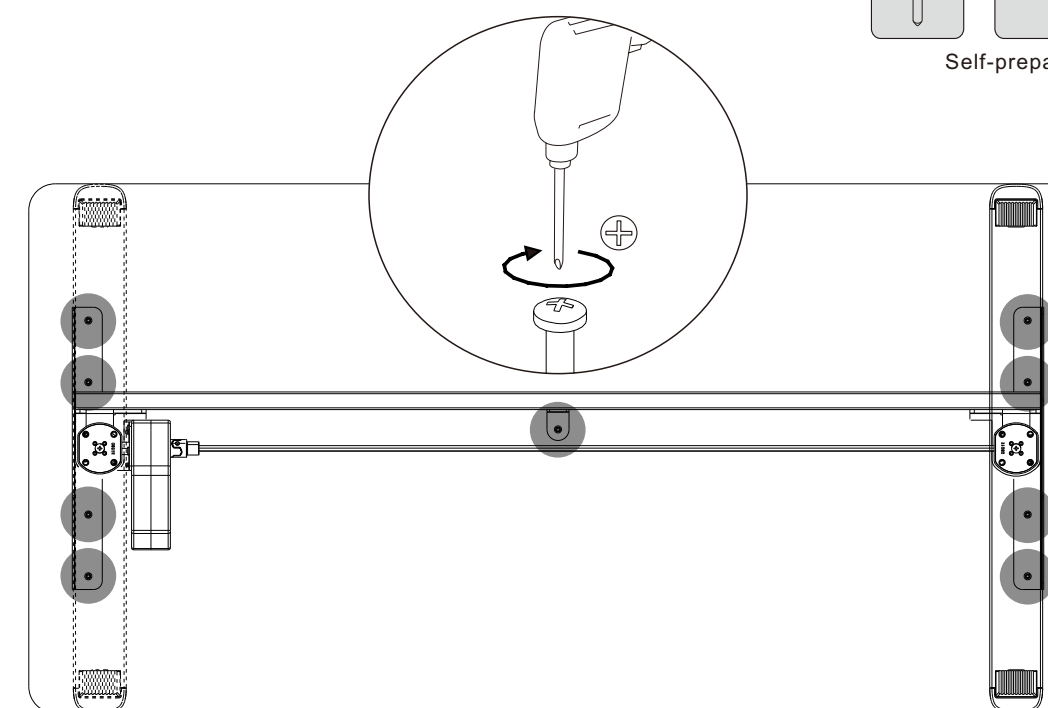

STEP9 Install the Handset

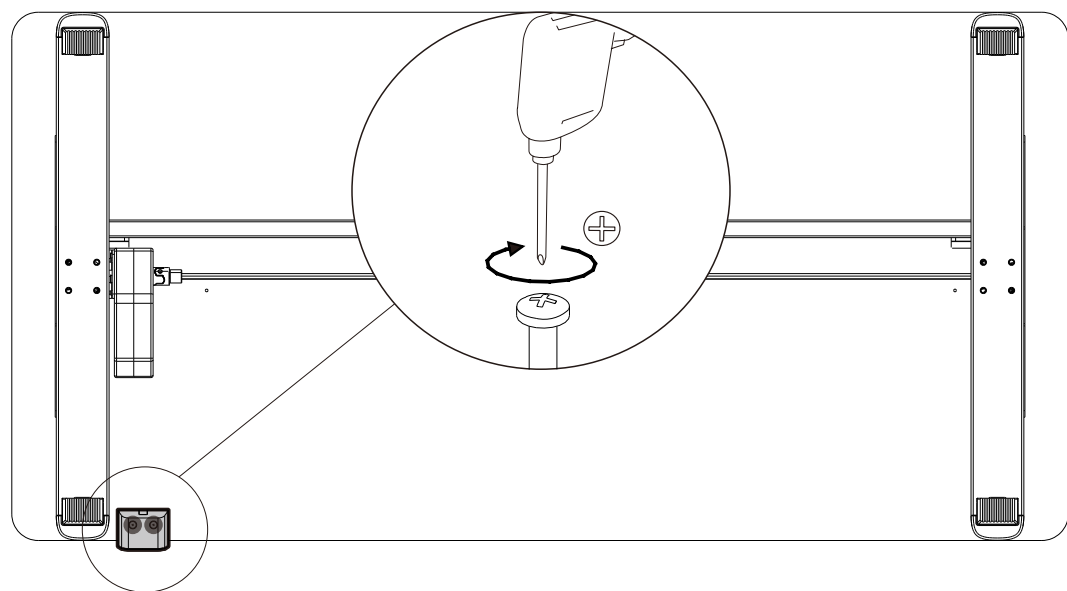
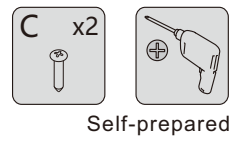

STEP10 Install the Baffle

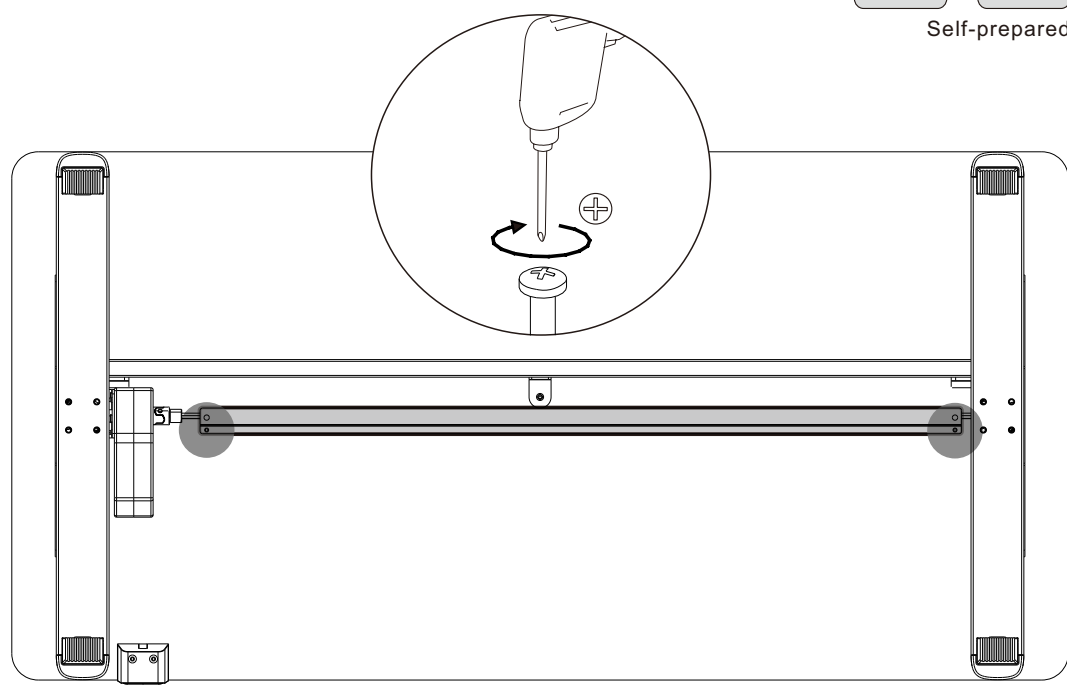
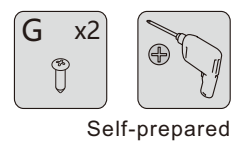

STEP11 Install and Route Power Cord

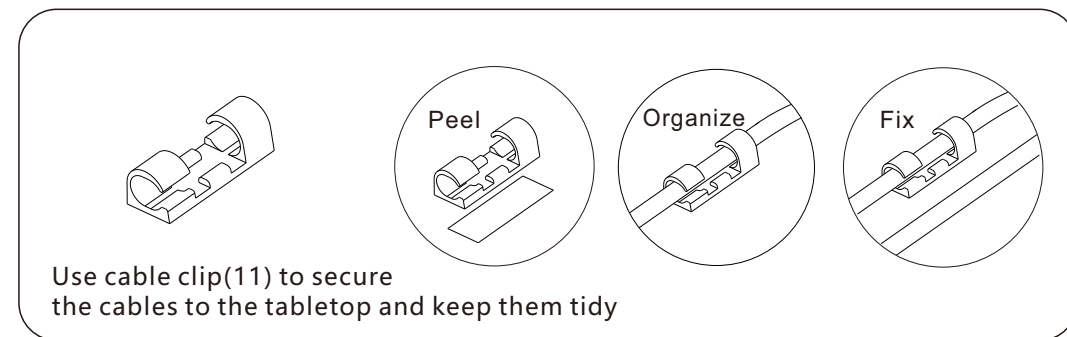
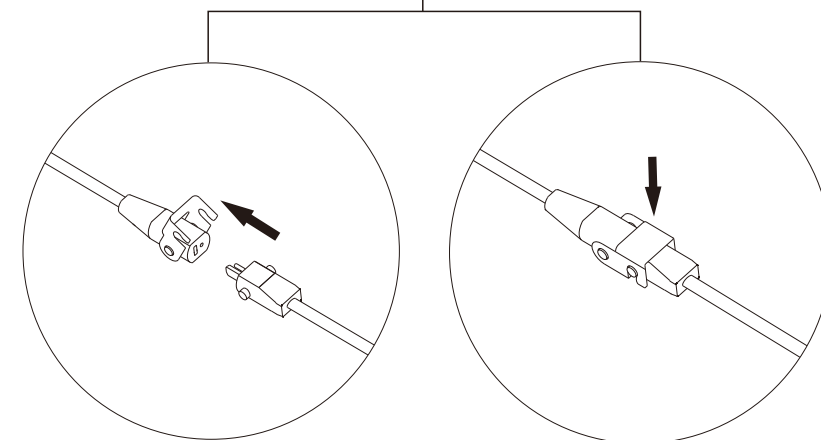
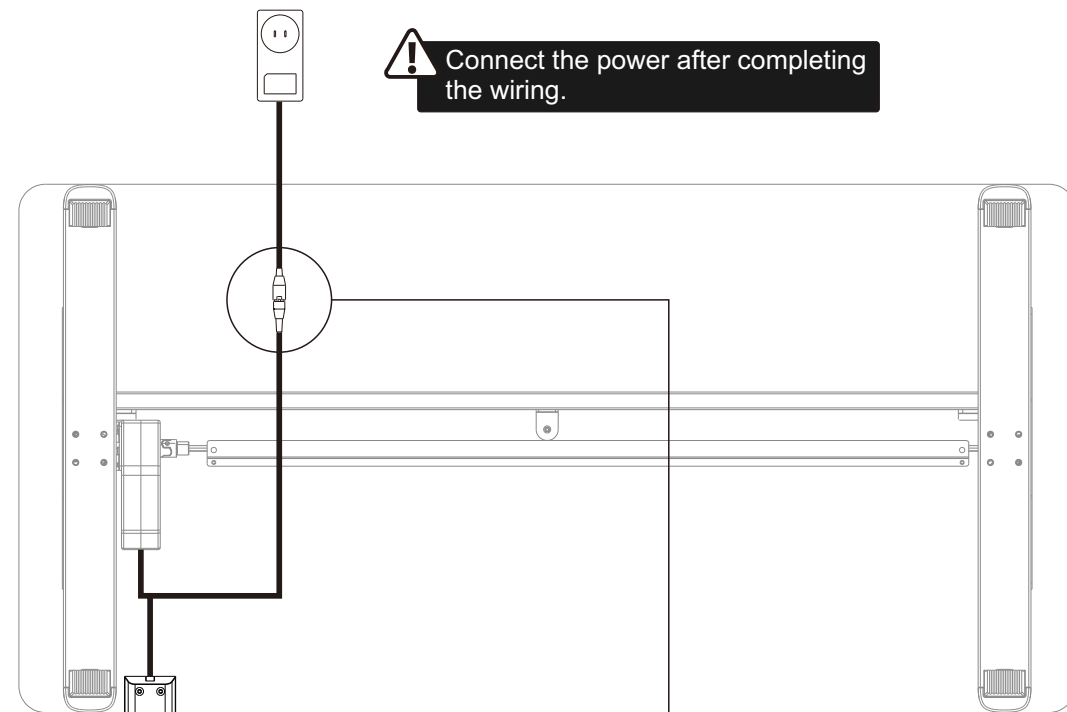

Handset control method and setting

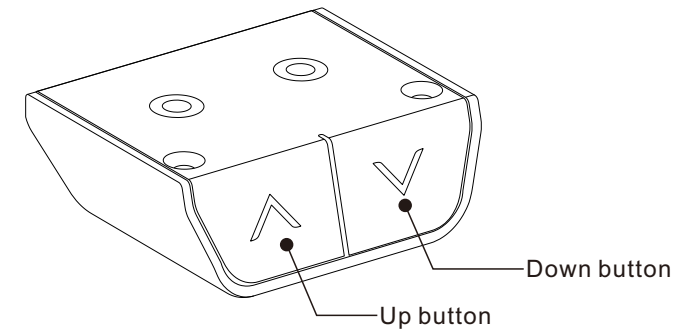

Attention Please make sure that there are no obstructions during the ascending and descending process of the desk, and all cables are long enough for the desk to go up and down.

● **Height adjustment function:**

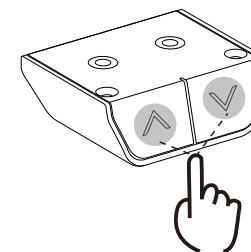

You can adjust the height of the standing desk up or down by pressing the " ^ " or " v " keys.

Resolving Common Issues

This list is used for checking and solving common faults and errors. Please contact the manufacturer if problem you encounter is not on the list below.

Problem	Solution
No response when pressing the UP or DOWN button	Check the cable connection
Speed of lifting is slow	Check if the load weighs more than 50kg (Max. Load capacity: 50kg)
The worksurface slides downward	

Attention

1. Power supply: AC100V-240V, 50/60Hz
2. Service Environment: 0-40°C
3. Unplug the power plug before cleaning, wipe the dust on surface with slight wet dishcloth when cleaning, be careful not to let the drops into the internal parts, not loose the connector.
4. The electric box contains electronic components, metals, plastics, wires etc., so dispose of it in accordance with each country's environmental legislation, not the general household waste.
5. Check carefully to ensure correct and complete assembly before using.
6. Be familiar with all functions and program settings of the product before first use.
7. Children are forbidden to play on the product because of unforeseen action when playing, so any dangerous consequences caused by this improper action will not be on manufacturers.
8. Slight noise caused by the V-ribbed belt or brake system due to structure will not have any effect on the use of the equipment.
9. Corrosive or abrasive materials are forbidden to clean the equipment. Must ensure that the cleaner used will not pollute the environment.
10. This appliance can be used by children aged from 8 years and above and persons with reduced physical, sensory or mental capabilities or lack of experience and knowledge if they have been given supervision or instruction concerning use of the appliance in a safe way and understand the hazards involved. Children shall not play with the appliance.
11. Cleaning and user maintenance shall not be made by children without supervision.
12. If the supply cord is damaged, it must be replaced by the manufacturer, its service agent or a similarly qualified person in order to avoid a hazard.
13. Please make sure there is no hazard sources in your operating environment. e.g., do not litter the tools around. Always be careful to treat the packaging materials in order to avoid any possible danger, e.g. plastic bag may lead to choking hazard to children.
14. When more than two people are moving the product, please make sure that there is nothing on the table. And close the drawers, doors, etc., also confirm that the screws are not loose, and unplug the power plug. If necessary, please keep the original packaging of this product in case you need to use it for future transportation.
15. When storing for a long time, please unplug the plug, clean up the items that are easy to fall, and store it in a cool and dry place.

Waste disposal

This marking indicates that this product should not be disposed with other household wastes. To prevent possible harm to the environment or human health from uncontrolled waste disposal, recycle it responsibly to promote the sustainable reuse of material resources. To return your used device, please use the return and collection systems or contact the retailer where the product was purchased. They can take this product for environmental safe recycling.